

Pressure Gauge

standard - lower mount

dim 40, 50 and 63 mm

E 02.01.01

ed.17.01

Application	Standard pressure gauge. Suitable for media that will not obstruct the pressure system or attack copper alloy parts
Design	EN 837-1
Type	Serie 2040
WIKA type no	111.10
Case diameter	Dim 40, 50 and 63 mm
Accuracy	Class 2,5%
Case	Black plastic case
Window	Plastic, snap-fit
Pressure element	Copper alloy
Pressure unit	Bar. Option also bar/Pascal, psi or bar/psi
Scale	White plastic scale
Pressure connection	Dim 40 = G 1/8" Dim 50 and 63 = G 1/4"
Mounting	Lower mount
Pressure limitation	75% of full scale value by steady pressure 66% of full scale value by fluctuating pressure By short time pressure full scale value
Permissible temperature	Medium temperature max -20 till +60°C Ambient temperature max -20 till +60°C
Production options	Accuracy 1,6% Black painted steel case Other pressure connections



2040
Lower mount

case dim 40



2040
Lower mount

case dim 50



2040
Lower mount

case dim 63

Pressure Gauge

standard - lower mount
dim 40, 50 and 63 mm

E 02.01.01

Pressure range	Interval	Divisions
0-0,6 bar	0,02	30
0-1 bar	0,05	20
0-1,6 bar	0,05	32
0-2,5 bar	0,1	25
0-4 bar	0,2	20
0-6 bar	0,2	30
0-10 bar	0,5	20
0-16 bar	0,5	32
0-25 bar	1,0	25
0-40 bar	2,0	20

Pressure range	Interval	Divisions
0-60 bar	2,0	30
0-100 bar	5,0	20
0-160 bar	5,0	32
0-250 bar	10,0	25
0-400 bar	20,0	20
-1/0 bar	0,05	20
-1/+1,5 bar	0,1	25
-1/+3 bar	0,2	20
-1/+5 bar	0,2	30
-1/+9 bar	0,5	20

Accuracy

Max permissible error 2,5%

The accuracy is expressed as a percentage of full scale range. Permissible error 2,5% will cover 0% till 100% of scale range with a reference temperature of +20°C.

Ex. Pressure range 0-10 bar has an error of $\pm 0,25$ bar

Temperature effect

Temperature effect

Temperature of the measuring system over or under the reference temperature +20°C will effect the accuracy with 0,4 percentage per +10°C. With a medium temperature of +40°C the accuracy will be $\pm 3,3\%$.

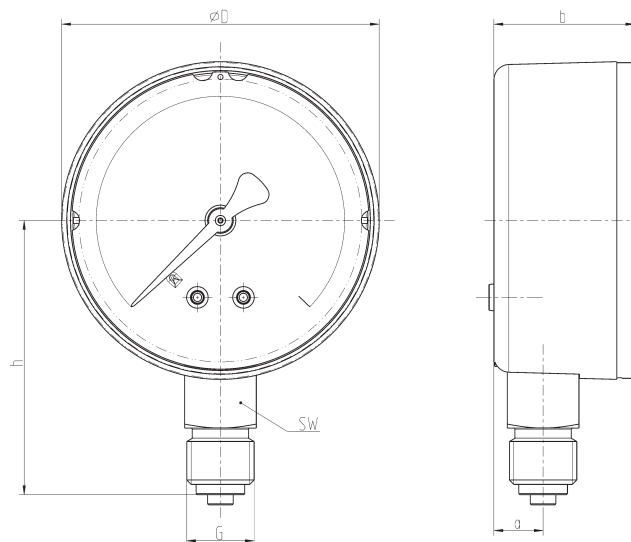

Dim \varnothing	a	b	b_1	b_2	D	G	h	SW	weight
40	9,5	26	-	-	39	G1/8"	36	14	0,08
50	9,5	27,5	-	-	49	G1/4"	45	14	0,10
63	9,5	27,5	-	-	62	G1/4"	53,5	14	0,13





Pressure Gauge

standard - lower mount

dim 40, 50 and 63 mm

E 02.01.01

Design with single scale in bar

			
	dim 40 mm	dim 50 mm	dim 63 mm
Connection	G1/8"	G1/4"	G1/4"
0-0,6 bar	x	x	20402001
0-1 bar	20400202	20401002	20402002
0-1,6 bar	20400203	20401003	20402003
0-2,5 bar	20400204	20401004	20402004
0-4 bar	20400206	20401006	20402006
0-6 bar	20400207	20401007	20402007
0-10 bar	20400208	20401008	20402008
0-16 bar	20400211	20401011	20402011
0-25 bar	20400213	20401013	20402013
0-40 bar	20400215	20401015	20402015
0-60 bar	20400217	20401017	20402017
0-100 bar	20400219	20401019	20402019
0-160 bar	20400220	20401020	20402020
0-250 bar	20400222	20401022	20402022
0-400 bar	20400224	20401024	20402024
-1/0 bar	20400240	20401040	20402040
-1/+1,5 bar	x	x	20402066
-1/+3 bar	x	x	20402067
-1/+5 bar	x	x	20402068
-1/+9 bar	x	x	20402069



Pressure Gauge

standard - lower mount

dim 40, 50 and 63 mm

E 02.01.01

Special design on stock with dual-scale in bar and Pascal

		
	Husdim 63 mm	Husdim 63 mm
Anslutning	G1/8"	G1/4"
0-2,5 bar/kPa	x	20402044
0-10 bar/MPa	20411708	x
0-40 bar/MPa	20401715	x

Special design on stock with dual-scale in bar and psi

				
	Husdim 40 mm	Husdim 40 mm	Husdim 50 mm	Husdim 63 mm
Anslutning	G1/8"	1/8"NPT	1/4"NPT	G1/4"
0-2,1 bar/30 psi	x	20400714	20401614	x
0-4 bar/60 psi	20400517	20400717	x	x
0-11 bar/160 psi	x	20400720	x	x
0-12 bar/170 psi	20400522	x	x	20402812

Special design on stock with single scale in psi

		
	Husdim 40 mm	Husdim 50
Anslutning	G1/8"	1/4"NPT
0-30 psi	x	20401514
0-60 psi	20400417	20401517
0-100 psi	20400419	x
0-160 psi	20400420	x